



# OPENCOMM 2 UC

BONE CONDUCTION BLUETOOTH HEADSET 



Price: \$199.95 USD  
Color: Black

\* With Shokz Loop110 USB-A/USB-C Wireless Adapter.



## Open-Ear Design, All-Day Comfort

The OpenComm2 UC brings you an advanced open-ear design for superb, all-day comfort, and sustained situational awareness. Seventh-generation bone conduction technology ensures crystal-clear audio while an adjustable, dual noise-canceling microphone delivers high-quality calls. And with the Shokz Loop110 wireless adapter, you'll always be connected to your devices, whether you use a Mac or a PC, in the office or at home.



## Advanced Open-Ear Design

Unlike traditional headsets that cover your ears and cut you off from your surroundings, OpenComm2 UC's open-ear design keeps you connected to the world without compromising on comfort or audio quality.

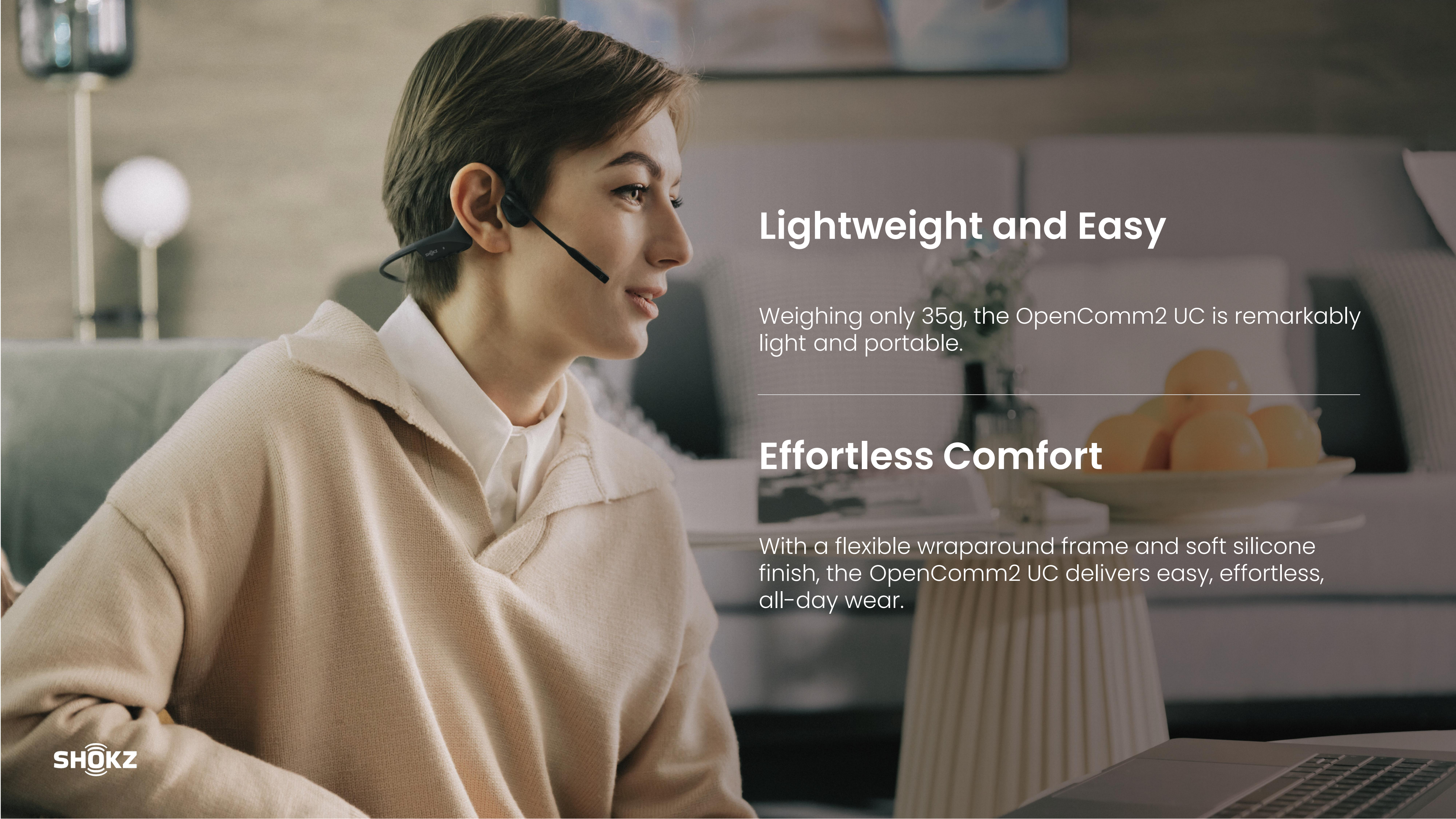

## Lightweight and Easy

Weighing only 35g, the OpenComm2 UC is remarkably light and portable.

---

## Effortless Comfort

With a flexible wraparound frame and soft silicone finish, the OpenComm2 UC delivers easy, effortless, all-day wear.



## Crystal-Clear Calls

Bring conversations to life and take calls with crystal-clear audio, thanks to a noise-canceling microphone with Digital Signal Processing (DSP) technology that brings your voice to center stage. Clear Voice Capture (CVC) technology identifies and balances vocals by filtering out ambient noise for end-to-end high fidelity. For even more precision, the slim and easily adjustable boom mic can be positioned for optimal voice capture and rotated away when not in use.



## Outstanding Audio Quality

Never miss a word during important calls with seventh-generation bone conduction technology and PremiumPitch™2.0. The OpenComm2 UC accurately picks up and equalizes medium and high-frequency vocals, ensuring you hear every word distinctly and without distortion.



## PC and Mac Compatibility

Whether you're working on PC or Mac, the Shokz Loop110 wireless adapter keeps your connection stable and uninterrupted. Move freely while always staying connected with a wireless range of up to 30m/98ft. Simply plug in your wireless adapter and start working.

A photograph of two women in an office environment. The woman in the foreground is wearing a white and blue striped shirt and a black headset with a microphone. She is looking towards the right. The woman in the background is wearing a pink blouse and a black headset with a microphone. She is smiling and looking at the first woman. They are both looking at a laptop screen. The background shows a window with a view of a city skyline.

## Stay Connected and Situationally Aware

Working from home, in the office, or on the go often requires situational and sensory awareness. With the OpenComm2 UC's open-ear design you're always connected to your surroundings so you never miss a beat.





**Work with total efficiency.**

**In the office:** Experience improved communication and easier collaboration.

**At home:** Stay connected to your work without missing out on what's happening at home.



**Speak with controlled clarity.**

Whether you're at the office, a coffee shop, or the airport, an advanced open-ear design with simplified audio control keeps you aware of your voice levels, ensuring you're heard without disturbing others.



## Multipoint Pairing

Pair your headset with up to two devices at a time, and enjoy easy switching capabilities for seamless connection and improved work efficiency.



## User-Friendly Integrated Controls

Integrated headset operations reduce PC or mobile device controls to simplify functionality. Simply press a button to adjust the volume, mute and unmute during calls, play or pause audio, check the battery level, and more.



## Improved Communication with Battery Life That Lasts

High-sensitivity technology delivers long-lasting battery power. Master uninterrupted communication so you can be online anytime, anywhere.

Up to

**16 Hours**

of talk time

Up to

**8 Hours**

of listening time

Quick Charge

**5 minute charge**  
for **2 Hours**

of talk time

**60 minute**

for full charge



## Moisture-Resistant Durability

Worry less about splashes and light spills with IP55 water-resistant durability and the microphone's water-resistant acoustic mesh.

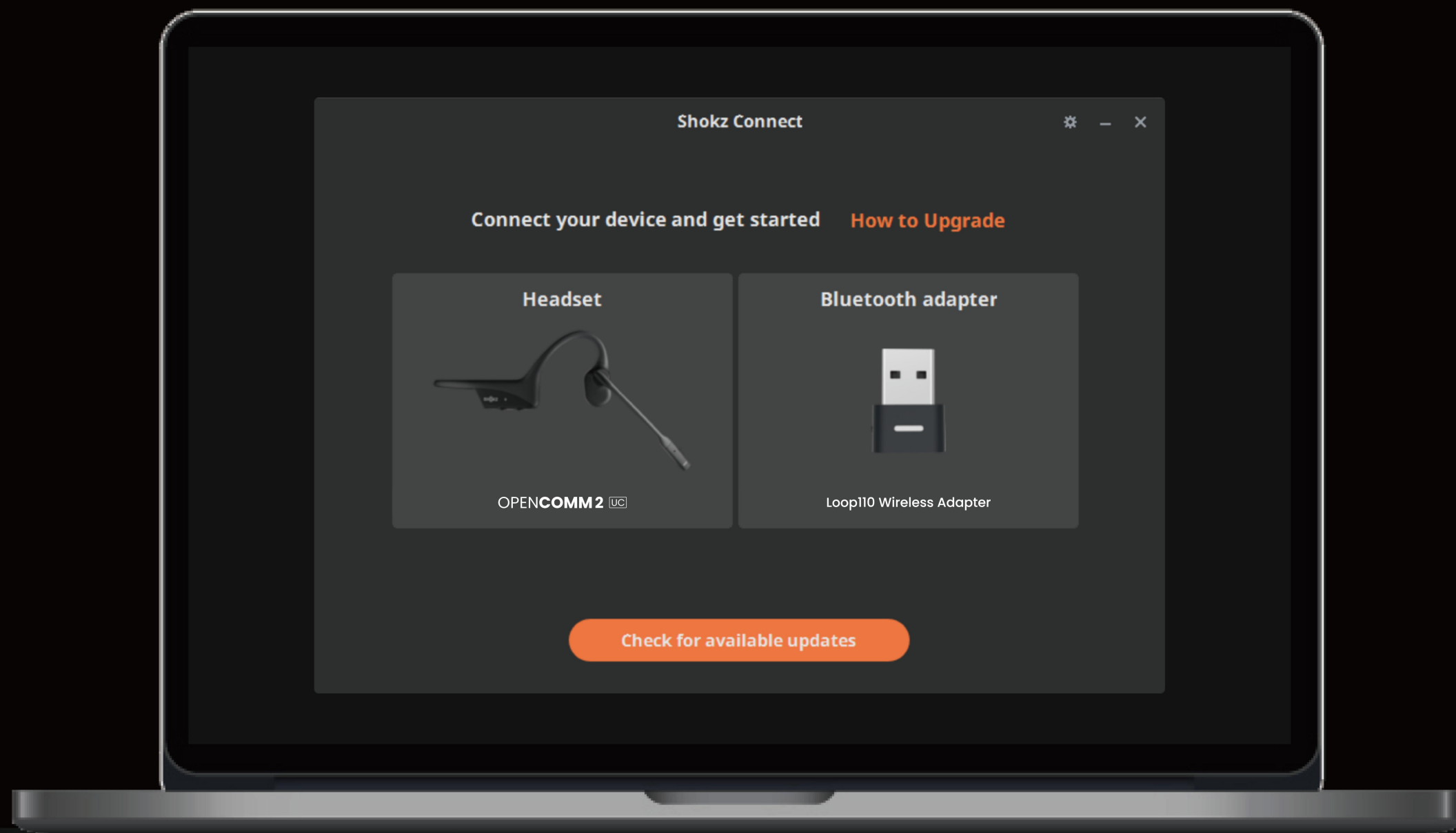

## Shokz Connect

Shokz Connect supports firmware upgrades. Never miss a function upgrade, and keep your headset up to date with the latest firmware so you can perform at your best.

## What's In The Box

- OpenComm2 UC Bone Conduction Stereo Bluetooth Headset
- Shokz Loop 110 USB-A Wireless Adapter
- Magnetic Induction Charger
- Hard Shell Carrying Case





# SPEC



Part number	C110
Speaker type	Bone Conduction
Frequency response	20HZ-20KHZ
Speaker sensitivity	96±3 dB
Microphone sensitivity	-38dB±3dB

Compatible configuration files	A2DP, AVRCP, HSP, HFP
Charging voltage	5.0V±5%
Speaker impedance	8.5Ω±20%
Wireless range	Up to 98feet(30m)
Frequency band	2400-2483.5MHz
Battery	Lithium polymer battery
Talk time	Up to 16 Hours
Listen time	Up to 8 Hours
Standby time	Up to 14 Days
Charge time	60 minutes
Weight	35 grams
Warranty	2 years
Water resistant	IP55 rated
Battery capacity	183mAh
Maximum RF output power	10dbm
Bluetooth® version	Bluetooth® v5.1